

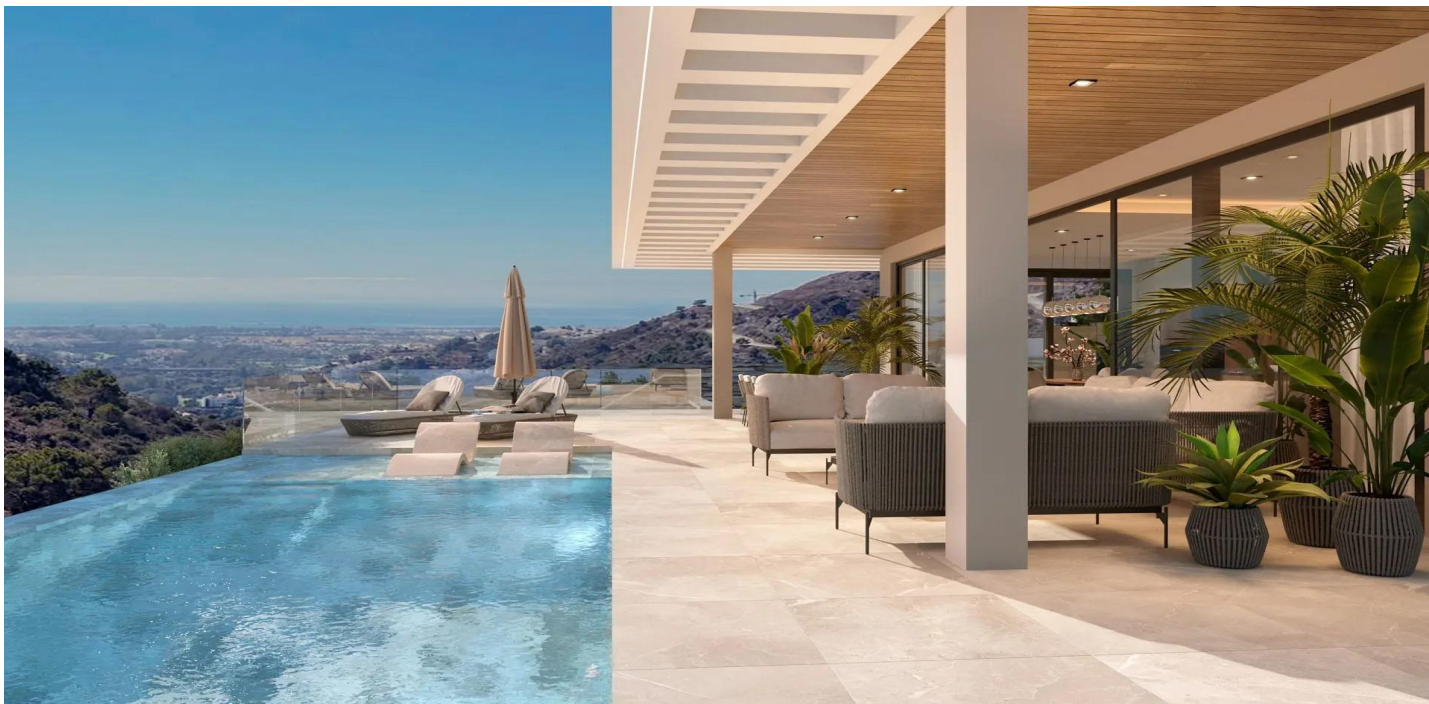

# Detached Villa for sale in Benahavís, Benahavís

6,500,000 €

Reference: SP0666 Bedrooms: 6 Bathrooms: 7 Plot Size: 3,035m<sup>2</sup> Build Size: 869m<sup>2</sup> Terrace: 110m<sup>2</sup>





## Costa del Sol, Benahavís

LUXURY NEW BUILD VILLAS WITH SEA VIEW IN BENAHAIVIS New Build villa have an orientation designed to maximise sunlight and take advantage of the magnificent panoramic views offered by the land on which they are located. Built with the highest quality materials, we take care of every detail of the project from the beginning of its execution until it is delivered to the client. The interior spaces have a unique and exclusive design combining modern and contemporary style with the highest performance. 6 Bedrooms 7 Bathrooms Built-up area 869 m2 Plot 3035 m2 Completion Date: 2025 A unique basement bathed in natural light thanks to the interior courtyard of the villa. It contains magnificent wellness areas such as the gym, the water area and the multipurpose recreation room. The gym will provide a fitness area with machines and weights of last generation, ideal for keeping fit and carrying out personalised exercise routines. It also offers a comfortable and private environment for yoga, pilates or other fitness activities. The water area is an oasis within the villa, including a stylishly designed sauna, therapeutic shower, Turkish bath, heated indoor pool. All exquisitely designed to combine luxury and relaxation for a 5-star spa experience in the comfort of your own home. The modern and cosy wine cellar is the perfect place for wine tastings and to admire the wine collection. In addition, the basement has a multi-purpose room that adapts to your needs, whether as a games room, home cinema or a versatile venue for any event you wish to celebrate. Eco-friendly construction with very low energy consumption. Modern and contemporary design, with glazed interior courtyards that illuminate each floor of the property, as well as large windows over 3 metres high so that the magnificent panoramic views become the most prominent feature of the main spaces of the villas. Floating floors of top quality enamelled porcelain stoneware and traditional floorboards of solid Galician pine. Reinforced wooden entrance door. Double and triple glazed sliding balcony doors with acoustic and solar control. Lift for up to 6 persons Top quality kitchen, with central island, silestone worktop and top brand appliances. Underfloor heating throughout the house. Common aerothermal equipment with the DHW system. Heat pump system of Daikin or similar brand, which allows for heating, cooling and domestic hot water. Outdoor unit located on the roof or in non-visible outdoor areas. Ample private outdoor parking for 3 vehicles. Spa with sauna, shower, Turkish bath and indoor heated pool. Electric entrance gate to the property with remote opening for vehicle access. Private landscaped garden with private outdoor swimming pool. Automatic irrigation system. Home automation system: pre-installation for CONTROL 4 system and 10" built-in screen.



## Features:

### Features

Near Commercial Center  
Beach: 8000 Meters  
Garden  
Gated  
Double Bedrooms: 6  
Under-Build / Basement  
Near Schools  
Elevator/Lift  
Air Conditioning: Pre-Installed  
Number of Parking Spaces: 2  
Private Pool  
Views: Sea  
Patio  
Terrace: 110 Msq.  
Location: Rural  
Useable Build Space: 650 Msq.

### Energy Rating

A

### CO2 Emission Rating

A